

**LWE**  
**LATHAM-WALTERS**  
**ENGINEERING, INC.**  
 N.C. CORP. LIC. C-1815  
 16507-A NORTHCROSS DRIVE  
 HUNTERSVILLE, N.C. 28078  
 PHONE: (704) 895-8484  
 FAX: (704) 237-4362

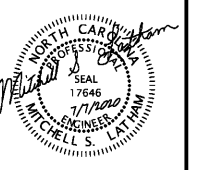

JULY 7, 2020  
 DATE

**ALBEMARLE ROAD**  
**PARTNERS, LLC**

568 JETTON STREET  
 SUITE 200  
 DAVIDSON, NC 28036  
 PH: 704-895-2084  
 watson@pleimontlanddevelopment.com

**ALBEMARLE ROAD SHOPS**  
 8837 ALBEMARLE ROAD CHARLOTTE, NC 28227  
**STORM DRAINAGE SYSTEM & EROSION**  
**CONTROL DRAINAGE AREA MAP**

REVISIONS

PROJECT NO.: 2019.13  
 SCALE: 1" = 40'  
 DRAWN BY: PAB  
 CHECKED BY: MSL

SHEET NO:  
**C13.0**

**Order Plans**

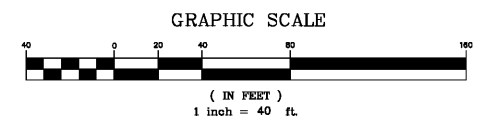
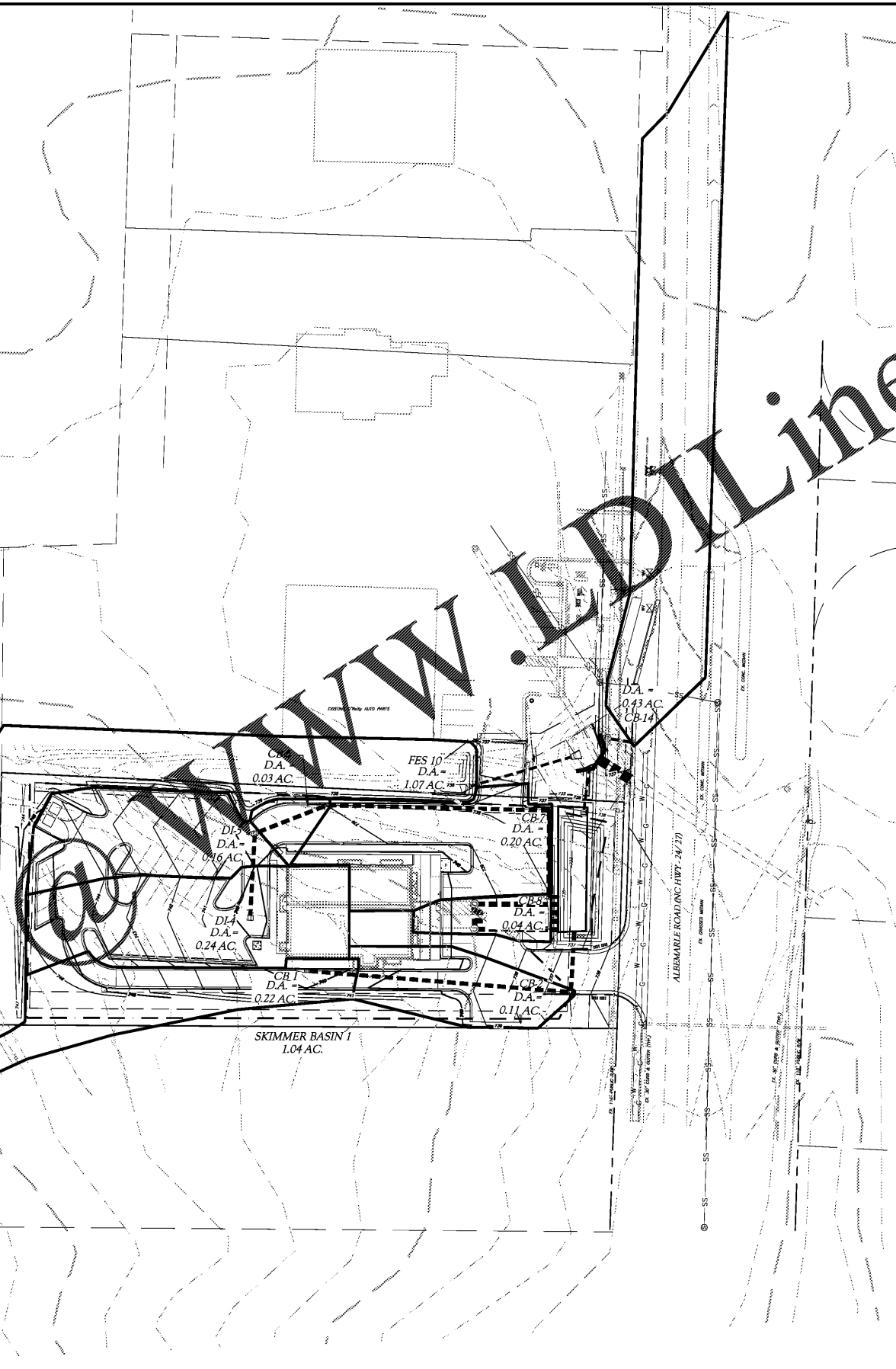

Know what's below.  
 Call before you dig.

1. CONTRACTOR IS FULLY RESPONSIBLE FOR CONTACTING APPROPRIATE PARTIES AND ASSURING THAT EXISTING UTILITIES ARE LOCATED PRIOR TO BEGINNING CONSTRUCTION.
2. CONTRACTOR IS RESPONSIBLE FOR PLACING BARRICADES USING FLAGMEN, ETC., AS NECESSARY TO INSURE SAFETY TO THE PUBLIC.
3. ALL PAVEMENT CUTS, CONCRETE OR ASPHALT, ARE TO BE REPLACED ACCORDING TO STANDARDS OF THE NORTH CAROLINA DEPARTMENT OF TRANSPORTATION.
4. SHORING WILL BE ACCORDING TO OSHA TRENCHING STANDARDS PART 1926 SUBPART P, OR AS AMENDED.