

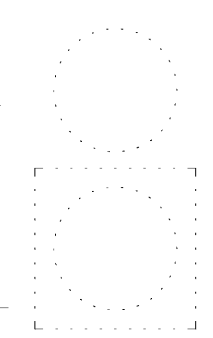

MAINTENANCE BUILDINGS



MEMBERS OF THE AMERICAN INSTITUTE OF ARCHITECTS

REVISIONS:

PROJECT: 9606-197950
DATE: 19 JUNE 2020
DRAWN BY: Author
CHECKED BY: Checker

DOOR SCHEDULE, DOOR TYPE LEGEND & FRAME TYPES
A-601

Table with columns: DOOR NUMBER, MATL, TYPE, FINISH, SIZE, HARDWARE, LABEL, STC, FRAME, TYPE, FINISH, HEAD, JAMB, SILL, REMARKS. Rows include 1ST FLOOR and various door types like 200A, 200B, etc.

Hardware Schedule table with columns: Door No., Description, Hardware, Qty, Unit, Remarks. Includes sections for Sets 1.0 through 19.0.

B4 DOOR HARDWARE SPECIFICATIONS

Order Plans @

EQUIPMENT / OVERHEAD DOORS

- 1. BASIS OF DESIGN, OVERHEAD DOOR COMPANY MODELS 426 AND 625.
2. ALL DOORS ARE MOUNTED ON INSIDE TRACKS AND INTERIOR SIDE MOUNTED LOCK.
3. ALL DOORS ARE ELECTRONICALLY OPERATED.
4. ALL DOORS CONTAIN JAMB WEATHERSEALS, BOTTOM WEATHERSTRIPS, AND BOTTOM SENSING EDGE.
5. ALL DOORS ARE INSULATED TO MEET CURRENT MINIMUM PRESCRIPTIVE ENERGY REQUIREMENTS.
6. ALL DOORS CONTAIN WINDOWS OR VIEW PORTS.
7. ARCHITECT TO SELECT FROM MANUFACTURER'S LIST OF STANDARD COLORS.
8. ALL NEW DOORS IN THE EQUIPMENT MAINTENANCE BUILDING TO USE STANDARD LIFT TRACKS AND CONTAIN EXHAUST PORTS.
9. ALL DOORS IN CART STORAGE AND CHEMICAL/FERTILIZER BUILDINGS TO BE COILING.

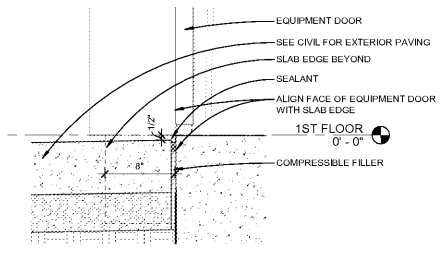

A2 EQUIPMENT DOOR SILL 1 1/2" x 1 1/2"

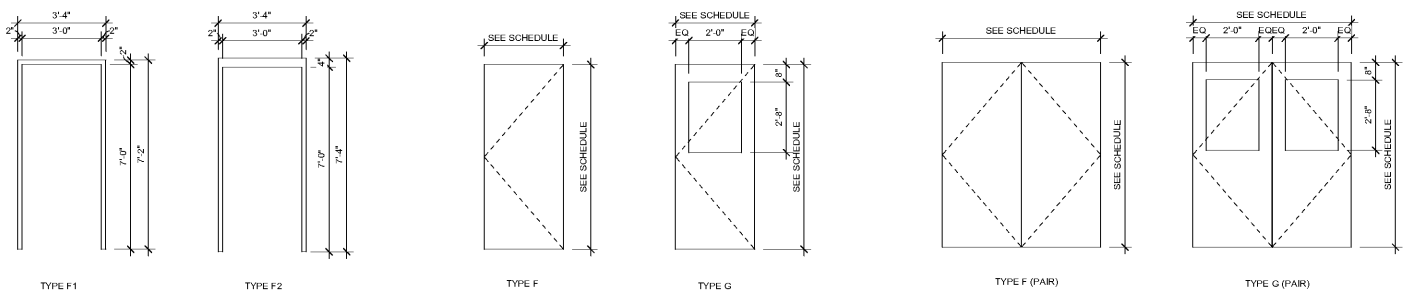

FRAME TYPE LEGEND, DOOR TYPE LEGEND, DOUBLE DOOR TYPE LEGEND