

**PROPOSED WATER MAIN EXTENSION**  
 SCALE (V): 1"=5'  
 SCALE (H): 1"=20'

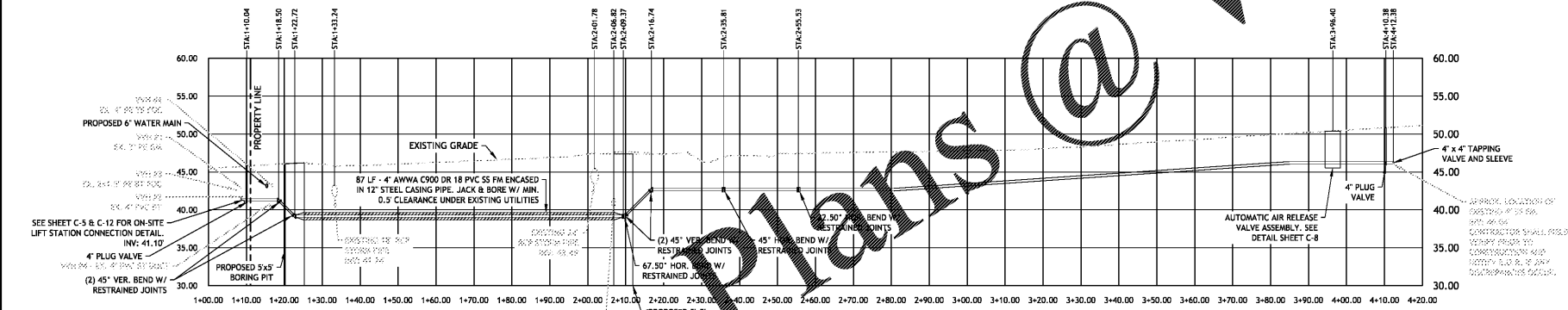

**PROPOSED FORCE MAIN EXTENSION**  
 SCALE (V): 1"=5'  
 SCALE (H): 1"=20'

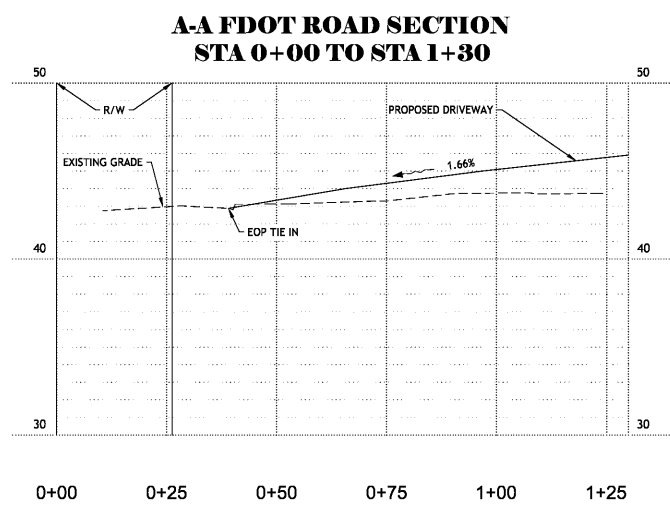

**DRIVEWAY PROFILE SECTION VIEW**  
 1"=20'

Order Plans @ [www.LDILine.com](http://www.LDILine.com)

**ISSUED FOR PERMITTING**

DESIGNED BY:	TS	DATE:	12/07/19
DRAWN BY:	JG	ISSUE DATE:	12/07/19
CHECKED BY:	TS	APPROVED BY:	LB
NO.:	1	DATE:	03/03/20
NO.:	2	DATE:	03/27/20
NO.:	3	DATE:	05/07/20

**BEACON CIVIL ENGINEERING**  
 LAND DEVELOPMENT ENGINEERS  
 8345 GUNN HIGHWAY  
 TAMPA, FL 33626

LAURIE S. BURCAW, PE #46064

**TAKE-5 OIL CHANGE**

OF **SEFFNER**

11909 E DR MARTIN LUTHER KING JR BLVD, SEFFNER, FL.

SHEET NAME:  
**UTILITY EXTENSION PROFILES**

SHEET NUMBER:  
**C-7**