



THIS DRAWING IS THE PROPERTY OF BRIDGESTONE RETAIL OPERATIONS, LLC AND IS LOANED ON THE EXPRESS CONDITION THAT IT IS NOT TO BE USED IN ANY WAY DEROGATORY TO THE INTERESTS OF BRIDGESTONE RETAIL OPERATIONS, LLC. ADMISSION TO THE EXCLUSIVE OWNERSHIP PLANS TO THE DRAWING BY BRIDGESTONE RETAIL OPERATIONS, LLC.

NEW FCAC STORE
 2020 ER
 1762 STATE RD
 SUMMERVILLE, SC

PROVIDED BY
 OTHERS FOR
 REFERENCE ONLY

| ISSUE BLOCK | |
|-------------|--------|
| 01/06/20 | REV #1 |

PROPERTY NO.: 317910
 6 DIGIT NO.: 798862
 4 DIGIT NO.: 013K

AOR PROJECT NUMBER: 1955867
 TO PERMIT DATE: 12-20-19
 TO BID DATE: ###-##-##

SHEET TITLE:
**PHOTOMETRIC
 SITE LIGHTING**

SHEET NUMBER:

PSL1

| Symbol | Qty | Label | Arrangement | LMF | Lum Lumens | Lum Watts | Part Number |
|----------|-----|-------|-------------|-------|------------|-----------|---|
| [Symbol] | 12 | N | SINGLE | 1.000 | 2490 | 19 | XSPW-B-WM-3ME-2L-57K-UL-BK (Wall Light) |
| [Symbol] | 3 | PL1 | SINGLE | 1.000 | 11648 | 86 | OSQ-A-NM-4ME-B-57K-UL-BK w/OSQ-DABK |
| [Symbol] | 1 | PL3 | 2 @ 90° | 1.000 | 11648 | 86 | OSQ-A-NM-4ME-B-57K-UL-BK w/OSQ-DABK |

| Calculation Summary (Footcandles calculated using predicted lumen values @ 50K hrs of operation) | | | | | | |
|--|-------|------|-----|-----|---------|---------|
| Label | Units | Avg | Max | Min | Avg/Min | Max/Min |
| CalePts | Fc | 2.12 | 7.8 | 0.1 | 21.20 | 78.00 |
| Paved Area | Fc | 2.52 | 7.8 | 0.8 | 3.15 | 9.75 |

Pole Schedule
 (3) SSS-5-7-25-CW-BS-1D-C-BK (25' X 5" STEEL SQUARE POLE)
 (1) SSS-5-7-25-CW-BS-2D90-C-BK (25' X 5" STEEL SQUARE POLE)
 Proposed poles meet 140 MPH sustained winds.

Additional Equipment
 (5) OSQ-DABK (Direct Arm Mount)

*** CUSTOMER TO VERIFY ORDERING INFORMATION AND CATALOGUE NUMBER PRIOR TO PLACING ORDER ***

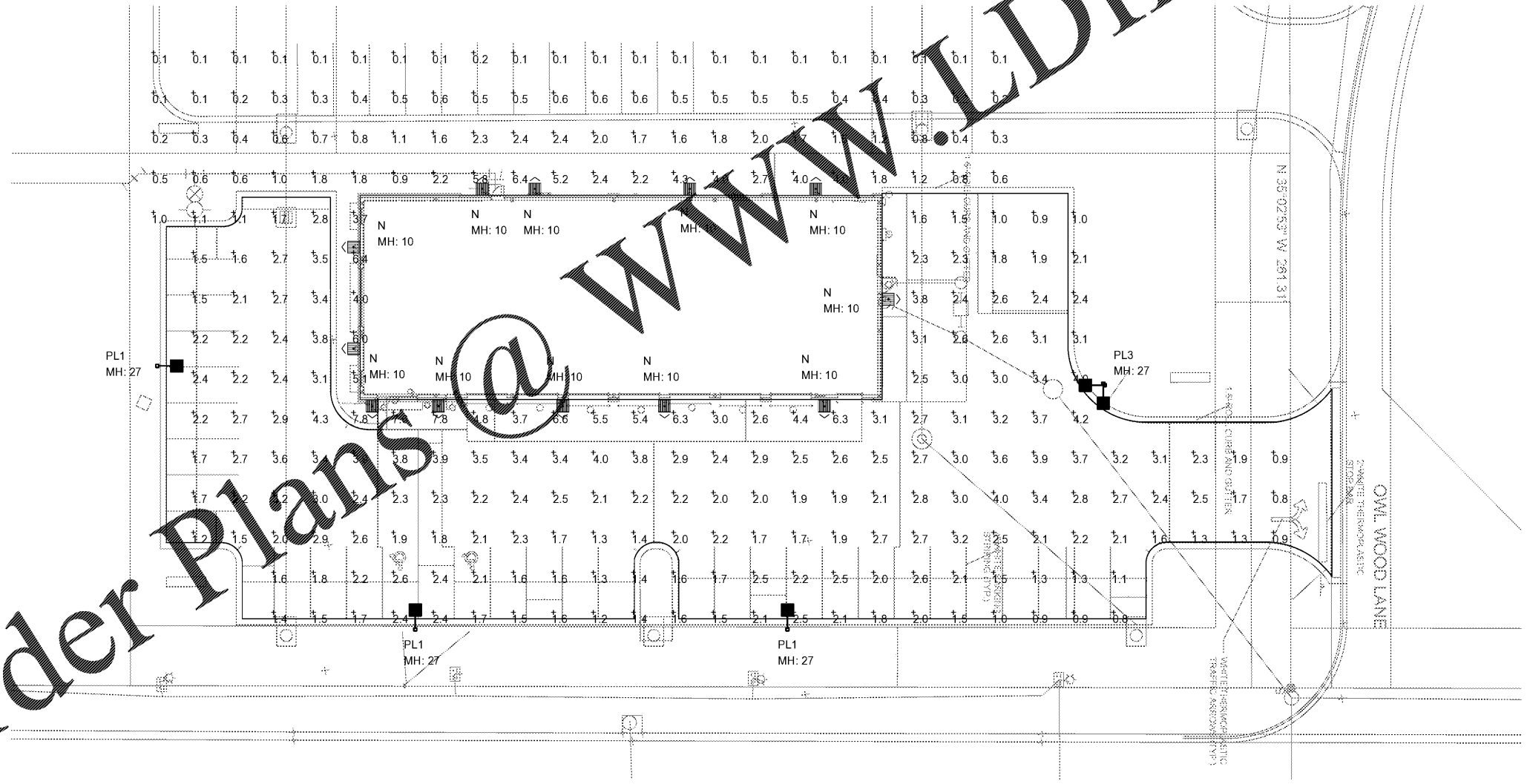
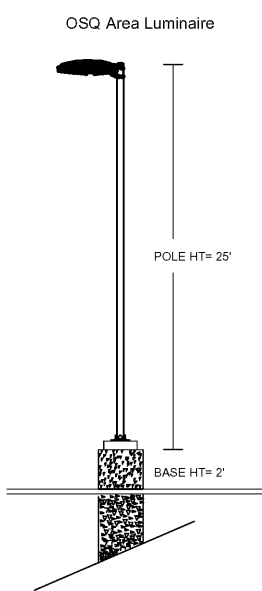

Order Plans @ WWW.LDILine.com

CREE LIGHTING
 A COMPANY OF IDEAL INDUSTRIES, INC.
 8201 Washington Ave, Racine, WI 53408 https://creeighting.com (800) 238-6800

Illumination results shown on this lighting design are based on proper parameters provided to Cree Lighting used in conjunction with luminaire test procedures conducted under laboratory conditions. Actual project conditions differing from these design parameters may affect field results. The customer is responsible for verifying dimensional accuracy along with compliance with any applicable electrical, lighting, or energy code.

Project Name: **BSRO Firestone - Cane Bay, SC**
 SR-39553
 Footcandles calculated at grade

Layout By: Chris Schiltz
 Date: 12/4/2019
 Filename: FRS-191114CBSCCIS1R1.AGI

Scale 1" = 16'

SHEET NUMBER:
PSL1