

GENERAL NOTES:

- UNLESS NOTED OTHERWISE, LIGHTING (NON-SHADED) IN THE FOLLOWING SPACES LABELED: LOUNGES, RECEPTION, MARKET, MAIL, VESTIBULE, PUB, GRILL, LIVING ROOMS, MULTIPURPOSE ROOMS, LIBRARY, CAFE, AND GREAT ROOM SHALL BE CONTROLLED VIA A LOW VOLTAGE LIGHTING CONTROL PANEL SYSTEM. THE CONTROL PANEL SHALL TURN ON LIGHTS AT FULL BRIGHTNESS (7:00 AM) AND DIM TO 50% AT 11:00 PM. THE OCCUPANCY SENSORS IN EACH OF THESE SPACES SHALL ONLY BE OPERABLE DURING THE OFF HOURS.
- UNLESS NOTED OTHERWISE, LIGHTING (NON-SHADED) IN CORRIDORS SHALL BE CONTROLLED VIA A LOW VOLTAGE LIGHTING CONTROL PANEL SYSTEM. THE CONTROL PANEL SHALL TURN ON ALL CORRIDOR LIGHTING(NON-SHADED) TO FULL BRIGHTNESS (7:00 AM - 11:00 PM) AND DIM TO 50% BETWEEN THE HOURS OF 11:01 PM TO 6:59 AM. THE OCCUPANCY SENSORS IN CORRIDORS SHALL ONLY BE OPERABLE DURING 11:01 PM TO 6:59 AM. HOWEVER IF DURING THE TIME THE LIGHTS ARE DIMMED AND OCCUPANCY IS SENSED, THE OCCUPANCY SENSOR SHALL RAISE LIGHTS TO 100% OCCUPANCY SENSORS IN THESE SPACES ARE ONLY TO BE ACTIVATED DURING THE DESIGNATED DIMMED TIME FRAME.
- PROVIDE QUANTITY OF BRIDGE AND ROOM CONTROLLERS IN EACH SPACE AS NEEDED.
- PROVIDE ALL WIRING REQUIRED FOR SWITCH LEGS AS NECESSARY.
- REFER TO LIGHT FIXTURE SCHEDULE FOR DIMMING TYPE (ELV OR 0-10V).
- CORRIDOR LIGHTING CONTROLS REQUIRE 0-10V DIMMING (TYPE A FIXTURES) AND ELV DIMMING (ALL OTHER FIXTURES).
- REFER TO ID DRAWINGS FOR INSTALLATION OF TYPE 'MMM' FIXTURES.
- CEILING FANS ARE TO BE WIRED AHEAD OF ROOM LTG CONTROLS.

DRAWING NOTES:

- LIGHTING (NON-SHADED) IN THIS AREA SHALL BE CONTROLLED VIA LOW VOLTAGE LIGHTING CONTROL PANEL SYSTEM. THE CONTROL PANEL SHALL TURN ON LIGHTING AT PRESET TIMES (DETERMINED BY OWNER). THE OCC SENSOR IN THIS SPACE SHALL DIM LIGHTS TO 50% WHEN UNOCCUPIED DURING THOSE HOURS. AFTER PRESET HOURS OCC SENSOR SHALL OPERATE LIGHTS TO TURN 100% ON AND 100% OFF WHEN SPACE IS OCCUPIED.
- CONTROL FOR CEILING FANS TYPE 'GG'.
- STAIRWELL FED FROM THIRD FLOOR LIGHTING CIRCUIT, SEE THIRD FLOOR PLAN FOR ADDITIONAL INFORMATION.
- UNLESS NOTED OTHERWISE, ALL NORMAL (NON-SHADED) LIGHT FIXTURES WITHIN THIS BOX SHALL BE CONNECTED TO THIS CIRCUIT.
- UNLESS NOTED OTHERWISE, ALL EGRESS (SHADED) LIGHT FIXTURES WITHIN THIS AREA SHALL BE CONNECTED TO LS1A-4.
- UNLESS NOTED OTHERWISE, ALL EGRESS (SHADED) LIGHT FIXTURES WITHIN THIS AREA SHALL BE CONNECTED TO LS1B-11.
- CONTROLS EXTERIOR TYPE 'AA' FIXTURES VIA CONTROL #7.
- UNLESS NOTED OTHERWISE, ALL EGRESS (SHADED) LIGHT FIXTURES WITHIN THIS AREA SHALL BE CONNECTED TO LS1A-9.
- UNLESS NOTED OTHERWISE, ALL EGRESS (SHADED) LIGHT FIXTURES WITHIN THIS AREA SHALL BE CONNECTED TO LS1B-11.
- PROVIDE LEGRAND RADIANT #RH4FBL3PTC FOR CONTROL OF TYPE 'MMM' IN ROOM.
- PROVIDE LEGRAND RADIANT #RH703PTC FOR CONTROL OF TYPE 'X' IN HALLWAY.
- REMOTE TRANSFORMER FOR LIGHTS TYPE 'X'. COORDINATE WITH FIELD CONDITIONS AND MANUFACTURING REQUIREMENTS PRIOR TO PURCHASE.

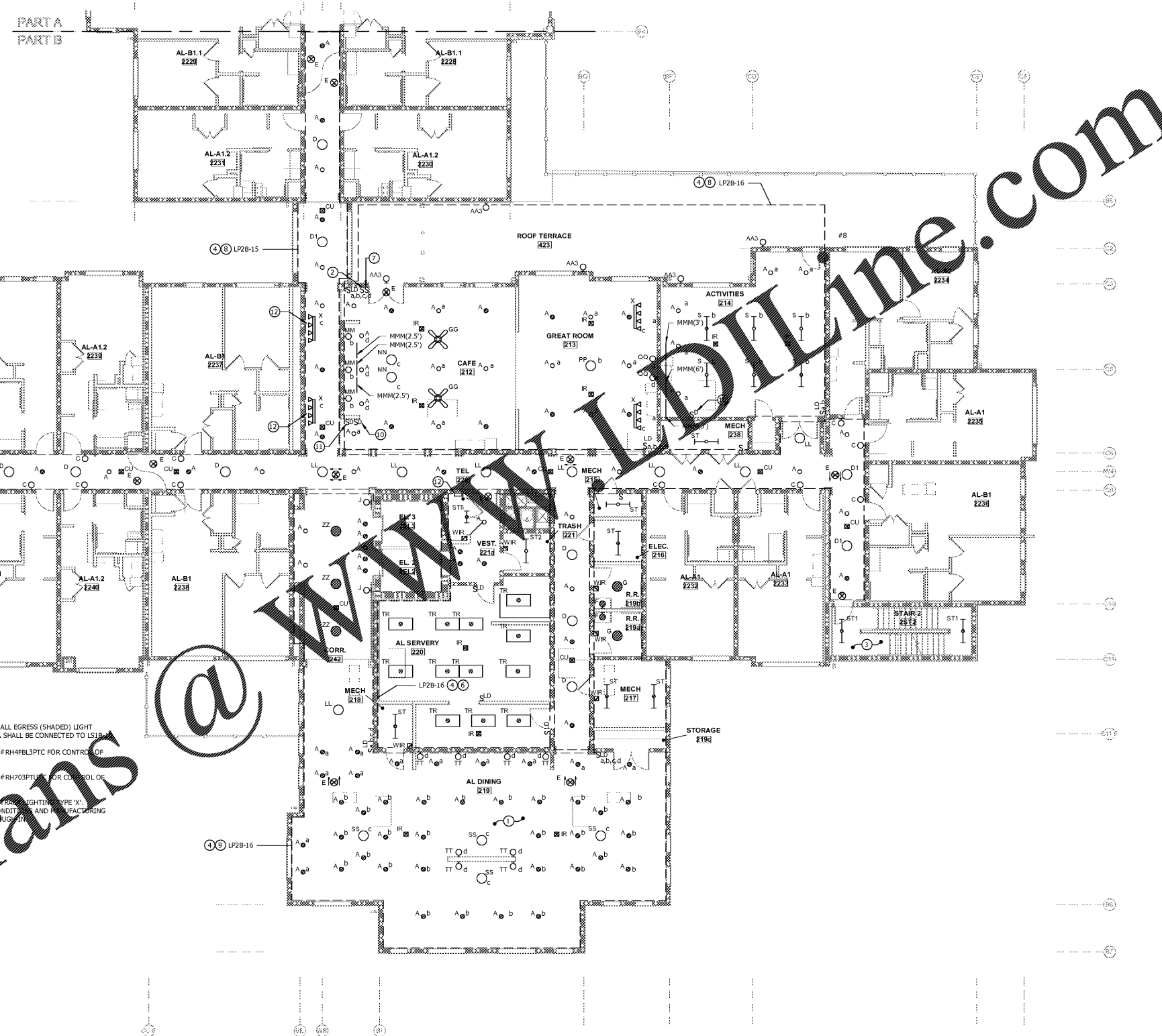

SECOND FLOOR LIGHTING - B
SCALE: 1/8" = 1'-0"

Order Plans @ www.dline.com

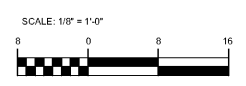
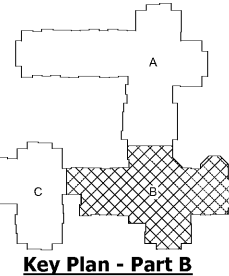

architect | designer
BCT ARCHITECTS
 100 North Charles Street, 18th floor
 Baltimore, MD 21201
 410.837.2727
 www.bctarchitects.com

structural engineer
CARROLL ENGINEERING, INC.
 215 Shilling Circle, Suite 102
 Hunt Valley, MD 21031
 410.785.7423
 www.carrolleengineering.com

mep engineer
KIBART, INC.
 901 Dulaney Valley Road, Suite 301
 Towson, MD 21286
 410.494.1111
 www.kibart.com

civil engineer
H.A. Inc.
 29A Leinback Drive
 Charleston, SC 29407
 1.843.752.1166
 www.hainc.com

landscape architect
LAND DESIGN, LLC
 200 South Peyton Street
 Alexandria, VA 22314
 1.703.542.7764
 www.LandDesign.com

interior designer
AUMEN ASNER
 100 North Charles Street, Suite 910
 Baltimore, MD 21201
 410.837.2767
 www.aumenasner.com

code & life safety consultant
KOFFEL ASSOCIATES, INC.
 8815 Centre Park Dr., Suite 200
 Columbia, MD 21045
 410.794.1610
 www.koffel.com

project
 DHEC Project Number #: 637063
BEES FERRY SENIOR LIVING
 3097 Bees Ferry Road
 Charleston, South Carolina 29414

client | owner
3097 BEES FERRY ROAD, LLC
 3535 Colonel Vandercost Circle
 Mount Pleasant, SC 29466
 1.843.296.3985

seal | signature

 10/18/2019

revisions

No.	Date	Title

sheet title
PARTIAL LIGHTING PLAN - LEVEL 2 - PART B

issue date 10/18/2019
 sheet number
E-121