

architect | designer

BCT ARCHITECTS
100 North Charles Street, 18th floor
Baltimore, MD 21201
410.637.2727
www.bctarchitects.com

structural engineer

CARROLL ENGINEERING, INC.
215 Shilling Circle, Suite 102
Hunt Valley, MD 21031
410.785.7423
www.carrolleengineering.com

mep engineer

KIBART, INC.
901 Dulaney Valley Road, Suite 301
Towson, MD 21284
410.494.1111
www.kibart.com

civil engineer

H.A. Inc.
29A Leinback Drive
Charleston, SC 29407
1.843.763.1166
www.hainc.com

landscape architect

LAND DESIGN, LLC
200 South Peyton Street
Alexandria, VA 22314
1.703.540.7764
www.LandDesign.com

interior designer

AJMEN ASNER
100 North Charles Street, Suite 910
Baltimore, MD 21201
410.837.2767
www.asmenasner.com

code + life safety consultant

KOFFEL ASSOCIATES, INC.
8815 Centre Park Dr., Suite 200
Columbia, MD 21045
410.794.1610
www.koffel.com

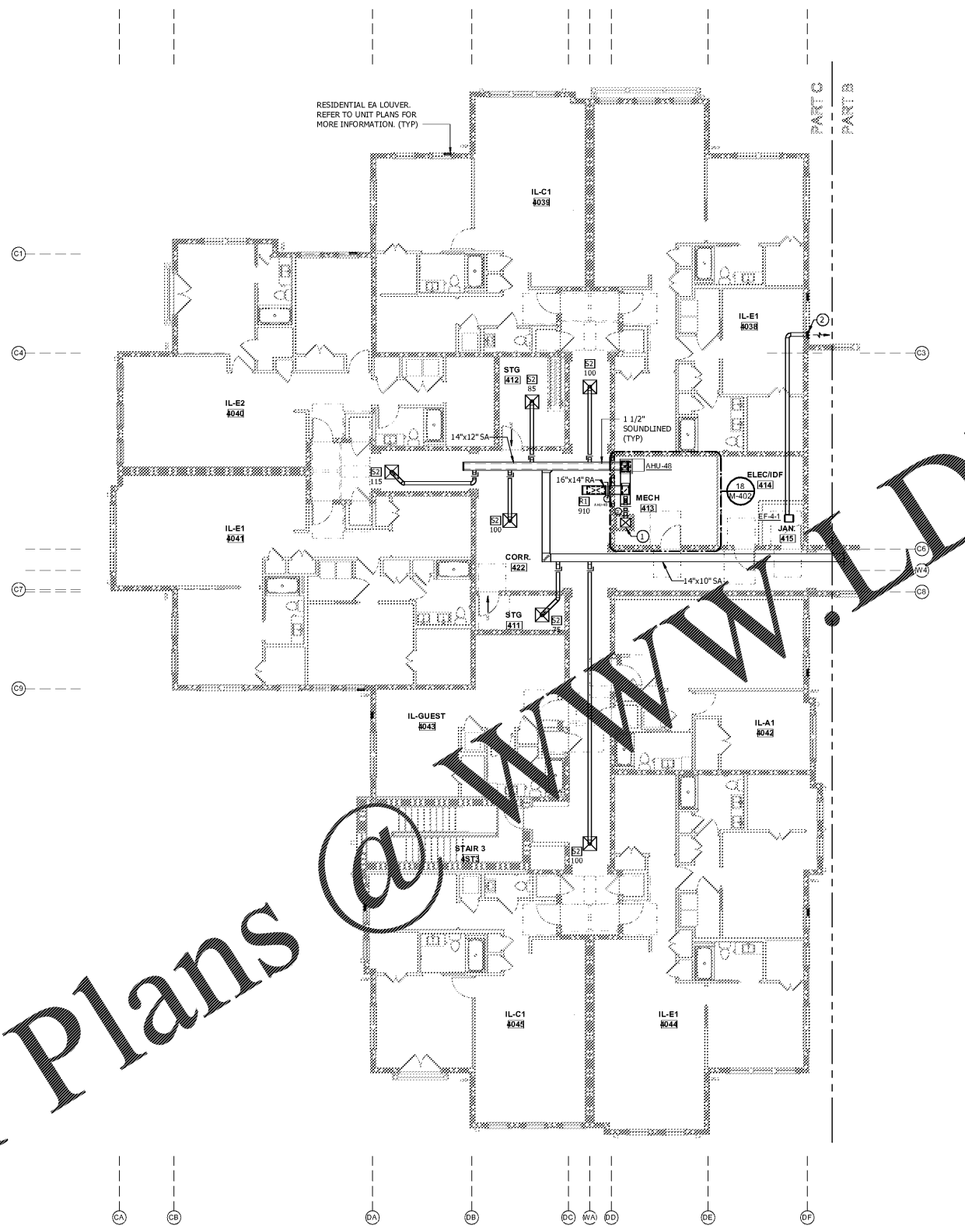

GENERAL NOTES:

1. ALL TOP FLOOR EXHAUST SHALL BE DISCHARGED THROUGH SOFFIT. REFER TO DETAIL - TYPICAL TOP FLOOR SOFFIT EXHAUST ON SHEET M-501 FOR ADDITIONAL INFORMATION.

DRAWING NOTES:

① 18x16 OUTSIDE AIR UNIT, OAH-3 0" ROOF AND DOWN TO THIRD FLOOR.

② PROVIDE 24" x 1'-0" EXHAUST AIR LOUVER WITH BIRDSCREEN AND 1" DEEP PLENUM.

Order Plans @ WWW.LDILine.com

FOURTH FLOOR PART PLAN - MECHANICAL - C
SCALE: 1/8" = 1'-0"

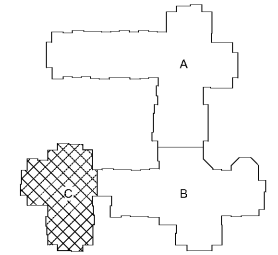

Key Plan - Part C
SCALE: 1" = 100'-0"

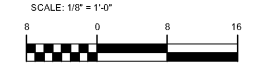

project

DHEC Project Number #: 637063

BEEES FERRY SENIOR LIVING
3097 Bees Ferry Road
Charleston, South Carolina 29414

client | owner

3097 BEEES FERRY ROAD, LLC
3535 Colonel Vanderveist Circle
Mount Pleasant, SC 29466
1.843.296.3985

seal | signature

10/18/2019

revisions

No.	Date	Title

sheet title

FOURTH FLOOR PART PLAN - MECHANICAL - C

issue date 10/18/2019

sheet number

M-212