



architect | designer
BCT ARCHITECTS
 100 North Charles Street, 18th floor
 Baltimore, MD 21201
 410.637.2727
 www.bctarchitects.com

structural engineer
CARROL ENGINEERING, INC.
 215 Shilling Circle, Suite 102
 Hunt Valley, MD 21031
 410.786.7423
 www.carrolengineering.com

mep engineer
KIBART, INC.
 901 Dulaney Valley Road, Suite 301
 Towson, MD 21286
 410.837.1111
 www.kibart.com

civil engineer
H.A. Inc.
 29A Leinback Drive
 Charleston, SC 29407
 843.752.1166
 www.hainc.com

landscape architect
LAND DESIGN, LLC
 200 South Peyton Street
 Alexandria, VA 22314
 703.542.7754
 www.LandDesign.com

interior designer
AUMEN ASNER
 100 North Charles Street, Suite 910
 Baltimore, MD 21201
 410.837.2707
 www.aumenasner.com

code + life safety consultant
KOFFEL ASSOCIATES, INC.
 8815 Centre Park Dr., Suite 200
 Columbia, MD 21045
 410.794.1610
 www.koffel.com

project
 DHEC Project Number #: 637063

BEES FERRY SENIOR LIVING
 3097 Bees Ferry Road
 Charleston, South Carolina 29414

client | owner
 3097 BEES FERRY ROAD, LLC
 3535 Colonel Vanderveht Circle
 Mount Pleasant, SC 29466
 843.296.3985

seal | signature

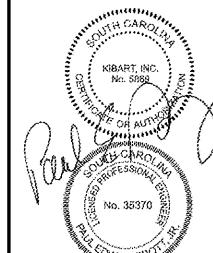

revisions

No.	Date	Title

sheet title

THIRD FLOOR PART PLAN - MECHANICAL - A

Issue date 10/18/2019

sheet number

M-207

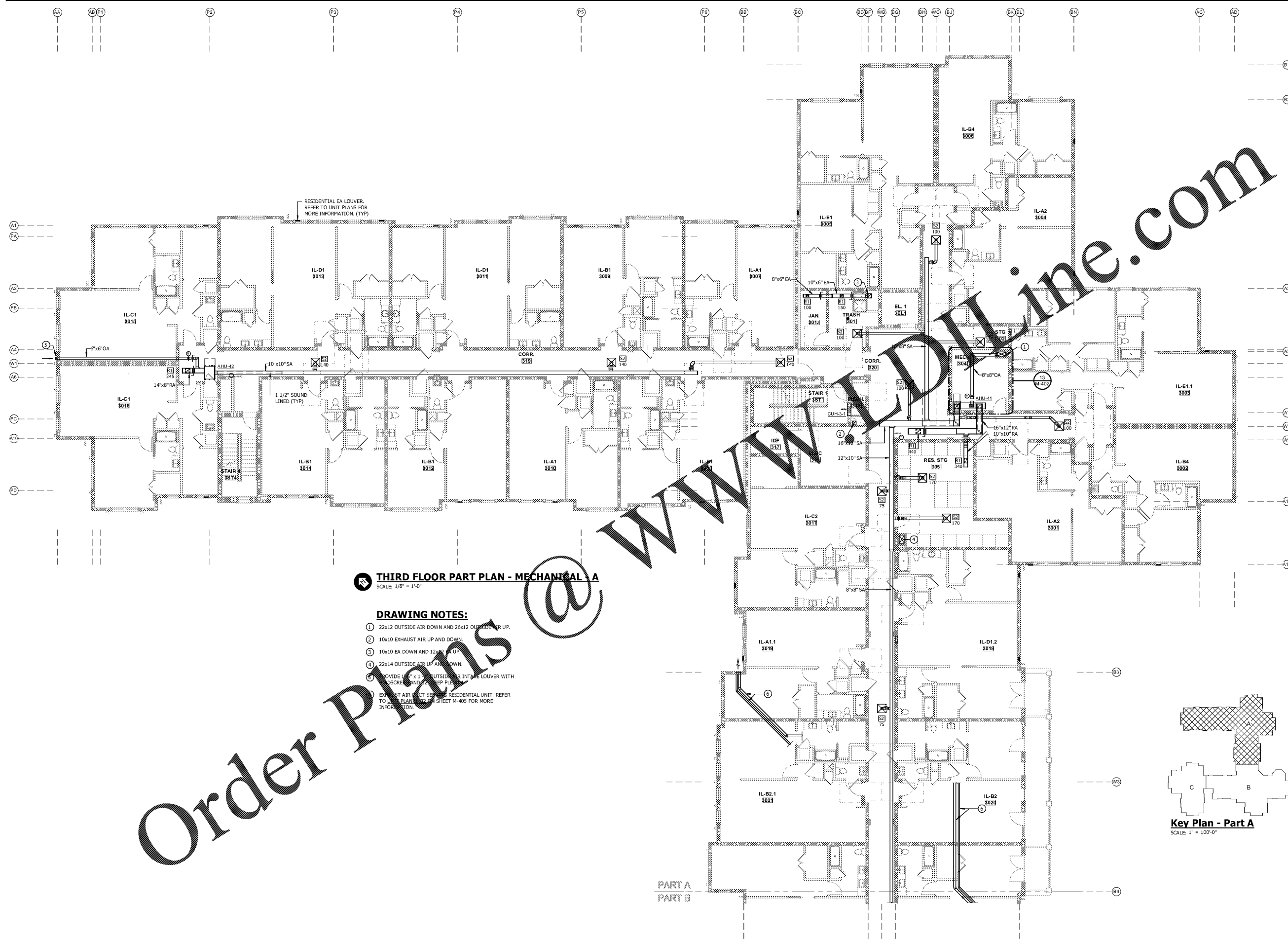

THIRD FLOOR PART PLAN - MECHANICAL - A
 SCALE: 1/8" = 1'-0"

DRAWING NOTES:

- 22x12 OUTSIDE AIR DOWN AND 26x12 OUTSIDE AIR UP.
- 10x10 EXHAUST AIR UP AND DOWN.
- 10x10 EA DOWN AND 12x14 EA UP.
- 22x14 OUTSIDE AIR UP AND DOWN.
- PROVIDE 1' x 1' OUTSIDE AIR INTO LOUVER WITH DISCRETE AND KEEP PL.
- EXHAUST AIR DUCT SERVING RESIDENTIAL UNIT. REFER TO UNIT PLAN ON SHEET M-405 FOR MORE INFORMATION.

Order Plans @ www.dpline.com

